

## ENVIRONMENTAL ACTION PLAN

<b>ISSUE (No)</b>	<b>PRINCIPAL AUTHOR</b>	<b>PRINCIPAL REVIEWER</b>	<b>ISSUE DATE</b>	<b>ISSUED TO</b>
<b>Issue 0.1</b>	Andrew Burwood	Emma Stevens	05.12.11	Birse Civils Lesley Clarke John Pygott Alison Hirst
<b>Issue 0.2</b>	Andrew Burwood	Emma Stevens	29.02.12	Alison Hirst Anthony Myatt Lesley Clarke Asite

## Introduction

This Environmental Action Plan (EAP) summarises the actions required to implement the Donna Nook Managed Realignment Scheme in accordance with the Environmental Statement (ES) that has been prepared following Environment Agency AMS guidance. It sets out specific objectives and targets defining the way in which we wish the ES and its findings to be addressed during the implementation phase of the project (e.g. detailed design, construction and post-construction phases). It also details roles and responsibilities of those involved in the proposal and refers to all **temporary** and **permanent** works.

A summary of the identified environmental constraints are indicated on the attached constraints plan. Key Environmental Risks of the Donna Nook construction works are:

- The northern boundary of the site borders the Humber Estuary Special Protection Area (SPA), Ramsar, Special Area of Conservation (SAC) and Site of Special Scientific Interest (SSSI). To protect overwintering birds, construction work cannot be carried out between November and March, and working restrictions apply in April and October.
- There is a breeding grey seal colony that pups at Donna Nook, east of the site entrance. This is a major visitor attraction between mid October and mid January; conflicts with visitors shall be avoided.
- There are water voles in the Seven Town South Eau close to Porter's sluice Pumping Station and Somercotes Haven Sluice, and in the drainage ditch close to the pond in the western section of the site. The water vole mitigation method statement shall be followed.
- There are badger setts throughout the site. The badger mitigation method statement shall be followed.
- There is a public car park (Stonebridge Car Park) at the end of Marsh Lane that needs to be kept open during the works. Access from the car park to the beach shall also be kept open.
- There is a Public Right of Way (PRoW) along the dunes and existing bank heading west from Stonebridge car park. The PRoW shall be kept open for as much of the construction period as possible, but temporary closures and diversions will be needed for some activities.
- The site entrance, main compound and eastern end of the new bank are close to Stonebridge Cottages; construction activities shall be planned to minimise disturbance to residents.
- Access to the site is along Marsh Lane, which also provides access to residential properties.
- Access to Somercotes Haven Tidal Sluice shall be maintained for the MoD and coastguard.

Detailed maps showing known water vole and badger sett locations are provided in the water vole and badger mitigation method statements.

This version of the EAP has been updated in February 2012 prior to construction. The document will remain live throughout construction and will be updated at key milestones.

## **Environmental Audit Coversheet**

The template should be used when undertaking any site audits during construction. Such audits can be undertaken by the NEAS Officer or by the officer's delegated representative. Technical assistance can be obtained from functional staff as appropriate.

## **Environmental Incident Reporting System**

An Environmental Incident is defined as a failure of an environmental constraint target or the occurrence of an environmental impact that was not identified in the ES. Failures must be reported by the Contractor to the NEAS Officer/Environmental Consultant/Environmental Clerk of Works (ECW) who, if necessary, will complete the Environmental Incident Report Form and advise on appropriate measures to limit impact. This procedure does not preclude the requirement to report relevant incidents in accordance with the requirements of the National Incident Reporting System (NIRS).

## ENVIRONMENTAL AUDIT COVERSHEET

### 1) Details of Proposal

<b>Title of Proposal:</b>	Donna Nook Managed Realignment Scheme	<b>Proposal Ref:</b>	IMNE000738		
<b>Project Manager:</b>	Anthony Myatt (EA)	<b>EIA Officer:</b>	Lesley Clarke		
<b>Location of Proposal:</b>	Donna Nook, North Somercotes, Humber Estuary Outer South Shore	<b>Grid Ref:</b>	542177 399827	<b>Catchment:</b>	Humber
<b>Type of Development:</b>	Managed realignment / flood defence	<b>Pre- Photos Located (y/n)</b>			

### 2) Site Visit Audit Details

<b>Visit During/Post Construction:</b>		<b>Date of Visit:</b>		<b>Time of Visit:</b>	
<b>Audit Officer:</b>		<b>Photos taken (y/n):</b>		<b>Referenced to Pre-Photos(y/n):</b>	

3) Does Site Supervisor have a copy of the EAP? Yes/No

### 4) General Comments

Ref. No.	Objective	Action	Responsibility	Ref. to Additional Information	Further Action / Comments	Sign Off	Date of Revision
<b>A PRIOR TO CONSTRUCTION</b>							
<b>1 HUMAN BEINGS AND HEALTH</b>							
A1.1	To communicate information about the proposed works	Public Liaison Officer will be appointed and made available for the duration of the works to inform those affected and to resolve any disputes or concerns. Particularly close liaison to be held with Stonebridge Cottages.	Environment Agency PM  Public Liaison Officer	Communications Plan	Public Liaison Officer may be a member of the contracting team appointed as first point of contact for public.		
		Undertake public consultation on footpath diversion.	Environment Agency Communications	Mike Dugher / Emma Stevens attended Parish Council meeting 28/11/11 and 21/01/12.  Public consultation event held on Village hall, 21/01/12		Yes	
		Notify local community of pre-main construction activities, e.g. breeding bird mitigation / UXO.	Environment Agency Communications		East Lindsey District Council (ELDC) has been advised in writing (December 2011).		
		Produce updated Communications Plan to detail planned consultation and communications routes.	Environment Agency Communications	Communications Plan			

Ref. No.	Objective	Action	Responsibility	Ref. to Additional Information	Further Action / Comments	Sign Off	Date of Revision
<b>A PRIOR TO CONSTRUCTION</b>							
A1.1 (contd)	To communicate information about the proposed works  (continued)	Public information notices will be displayed prior to works commencing, as identified in the Communications Plan.	Contractor. Format to be agreed with Environmental Project Manager (Environment Agency NEAS)	Communications Plan			
		Drop in sessions will occur if required and as identified in the Communications Plan.	Environment Agency Communications	Communications Plan			
		Notice of entry to be issued at least 7 days before the works commence for land not in Environment Agency ownership. Notices will include clear details of the nature and timings of works.  Notice to also be displayed in Stonebridge car park as ownership unknown	Environment Agency Communications / Estates				
A1.2	To ensure the safety of the local community	Produce a Health & Safety Plan for the works.	Contractor				
		Complete Public Safety Risk Assessment for design.	Environment Agency Area Client				

Ref. No.	Objective	Action	Responsibility	Ref. to Additional Information	Further Action / Comments	Sign Off	Date of Revision
<b>A PRIOR TO CONSTRUCTION</b>							
A1.3	To obtain consent for temporary diversions of Public Rights of Way (PRoW)	Arrange a footpath closure / diversion order with the Local Planning Authority (LPA) for the affected sections of Public Right of Ways.  Potentially needed for: <ul style="list-style-type: none"> <li>• Tie-in works</li> <li>• Pond improvements works</li> <li>• Mobilising/demobilising</li> </ul>	Consultant		Application for temporary closures submitted to Lincolnshire County Council, 15/02/12; tie in works.  Routes not confirmed yet.  LCC can take up to 13 weeks to process.		
		Closures will be notified at applicable access points along north and south as well as Stonebridge car park.	Contractor				
A1.4	Gain permanent footpath consents	Apply for stopping up order for breach and formally create new PRoW.	Consultant	Planning Decision Notice, Planning Condition 9	Application submitted to ELDC, 17/02/12.		
		Apply for formal permanent diversion of footpath 18 at car park if required.	Consultant		Not required based on landscape plans submitted to ELDC.		
A1.5	Ensure all consents are in place and conditions discharged	Review all consents (e.g. planning, Marine consent, etc) and add all conditions to EAP as required to ensure discharged.	Consultant	Planning Decision Notice	The requirements of the planning conditions have been added to version 0.2 of the EAP.		

Ref. No.	Objective	Action	Responsibility	Ref. to Additional Information	Further Action / Comments	Sign Off	Date of Revision
<b>A PRIOR TO CONSTRUCTION</b>							
A1.6	To limit noise and vibration	Contact will be made with ELDC Environmental Health Officer (EHO) to advise on site proposals. Noise limits and monitoring requirements agreed prior to works commencing.	Contractor				
		Prepare a noise monitoring plan prior to construction works commencing.	Contractor				
A1.7	Minimise disruption to local community	Register for the Considerate Contractor Scheme.	Contractor				
A1.8	Obtain LPA approval for measures to minimise disturbance to residents of Stonebridge Cottages from users of the new permissive path.	Design, supply details of and apply for written approval of measures to be taken to prevent that section of the historic embankment close to Stonebridge Cottages from being used by visiting members of the public to ELDC.	Consultant	Planning Condition 9			



Ref. No.	Objective	Action	Responsibility	Ref. to Additional Information	Further Action / Comments	Sign Off	Date of Revision
<b>A PRIOR TO CONSTRUCTION</b>							
A1.9	To protect workforce and public from unexploded ordnance (UXO)	Prepare a method statement on UXO clearance and check this with NE so that can do advance work in winter season.	Consultant	Magnetronomy Survey Email Birse to B&V of 04/11/11	Birse provided method to B&V on 04/11/11.  NE consulted by 'phone on 15/11/11 (Claire Weaver). No concerns raised; any controlled explosions to be done outside of 1.5 hours either side of high tide.  ELDC have been advised in writing of advanced works.	Yes	
		Carry out UXO clearance in winter in advance of main works.  No UXO excavations within 30m of any badger sett or 5m of any water vole ditch. Consult NE if any controlled explosions required within 100m of active sett.  No controlled explosions within 1.5 hours of high tide.	Consultant	As above	Anomaly investigations scheduled to start mid-December, for 4-5 weeks.  Investigations completed on 17/02/12.	Yes	

Ref. No.	Objective	Action	Responsibility	Ref. to Additional Information	Further Action / Comments	Sign Off	Date of Revision
<b>A PRIOR TO CONSTRUCTION</b>							
A1.10	To protect the workforce and members of the public from asbestos	Asbestos survey of pumping station	Contractor	Asbestos Survey Report	Asbestos detected within the roof of the existing pumping station at Donna Nook, and presumed to be present in fabric form in the wall mounted electrical cabinet. No further traces have been found.	Yes	
		Carry out a risk assessment for the works, and prepare an asbestos management plan for works to the pumping station.	Contractor	Asbestos Survey Report			
A1.11	To satisfy all planning requirements	Sign-off all pre-commencement planning conditions.	Environment Agency PM / Consultant	Planning Conditions			
A1.12	To avoid increased noise levels from the refurbished pumping station	During design, ensure new pumps will create equal or lower noise levels than the current pumps.	Consultant			Yes	

Ref. No.	Objective	Action	Responsibility	Ref. to Additional Information	Further Action / Comments	Sign Off	Date of Revision
<b>A PRIOR TO CONSTRUCTION</b>							
<b>2 FLORA AND FAUNA</b>							
A2.1	To prevent adverse effects to breeding birds. (All mitigation must be undertaken prior to main construction and also prior to the breach).	Working area must be demarcated so the spatial scope of mitigation can be defined.	Contractor				
		Site will be reverted to bare ground over winter and to be maintained as such to reduce its suitability for breeding birds.	Contractor		Natural England (NE) consulted by 'phone on 15/11/11 (Claire Weaver). No concerns raised.  ELDC have been advised in writing of advanced works.		
		Nest checks must be undertaken prior to construction by a qualified person. If found no works to occur until EcCW advises on how to proceed.	Ecological Clerk of Works (EcCW)				
		Where they are likely to be impacted by the works, hedgerows to be coppiced prior to breeding season to deter birds from using them. Where possible, hedges will be retained and buffer zones will be implemented around these features.	Contractor	Environmental Statement	Most hedges coppiced in 2010.		

Ref. No.	Objective	Action	Responsibility	Ref. to Additional Information	Further Action / Comments	Sign Off	Date of Revision
<b>A PRIOR TO CONSTRUCTION</b>							
A2.1 (con'd)	To prevent adverse effects to breeding birds  (continued)	Translocate within the site, hedgerows within the working area as directed by EcCW or consultant ecologist.	Contractor	Works Information: Hedgerow Translocation Method	To be undertaken in dormant season (November to February). Many hedges to be lost are of poor quality and not worth translocating.		
		Marginal vegetation within 20m of working areas alongside the Seven Towns South Eau (South Eau) and pond will be cut back prior to bird breeding season if required (March to September). Reeds to be 'topped'.  Vegetation to be kept short until works have been completed in those areas.	Contractor		NE consulted by 'phone on 15/11/11 (Claire Weaver). No concerns raised.		
		Pre-construction survey of those sections of the South Eau potentially disturbed by construction activity for kingfisher. Will be undertaken prior to works in each section.	Consultant Ecologist / EcCW		If breeding kingfisher are found then a 20m exclusion zone will be established until young have fledged.		
		Exclusion zones to be established where construction is not required.	Contractor				

Ref. No.	Objective	Action	Responsibility	Ref. to Additional Information	Further Action / Comments	Sign Off	Date of Revision
<b>A PRIOR TO CONSTRUCTION</b>							
A2.2	To maintain the integrity of the Humber Estuary SAC/SPA/Ramsar site/SSSI	Develop and agree Method Statement for works in dunes.	Contractor	Habitats Regulations Assessment	Contractor to prepare statement once B&V have provided detailed design and landscape drawings.		
		Prepare design for restoration of existing car park to sand dune.  Agree design with Natural England.	Consultant		Design agreed in principle with Technical Advisory Group (TAG) 28/11/11.  Design submitted to ELDC, 06/01/12	Yes	
		Prepare and submit to ELDC for written approval, a scheme for the mitigation and monitoring of over-wintering birds, particularly Brent Geese.	Environment Agency Legal and NEAS	Planning Condition 14	In progress.		

Ref. No.	Objective	Action	Responsibility	Ref. to Additional Information	Further Action / Comments	Sign Off	Date of Revision
<b>A PRIOR TO CONSTRUCTION</b>							
A2.2 (cont'd)	To maintain the integrity of the Humber Estuary SAC/SPA/Ramsar site/SSSI  (cont'd)	If works need to be carried out between 1st October and 30 April (the bird over-wintering and seal breeding season), write to ELDC to obtain their written agreement. ELDC may seek the views of NE.	Consultant	Planning Condition 13	NE have agreed to the relaxation of timings subject to certain restrictions (Claire Weaver by phone, 14/11/11).  ELDC have agreed that works can be allowed in April and October 2012, subject to working restrictions, as agreed with NE (letter 30/01/12).	Yes	
A2.3	To prevent adverse effects on protected species:  Otter	Pre-construction survey of the South Eau for otter in March 2012.	Consultant Ecologist		Survey will be undertaken at same time as water vole surveys. A spraint was found on the western levee bank in March 2010. However, the area is generally not considered to be suitable for holt or den sites due to its openness.		
		Develop mitigation measures if signs of otter presence or otters are observed.	Consultant Ecologist				

Ref. No.	Objective	Action	Responsibility	Ref. to Additional Information	Further Action / Comments	Sign Off	Date of Revision
<b>A PRIOR TO CONSTRUCTION</b>							
A2.4	To prevent adverse effects on protected species: Water Vole	Prepare water vole mitigation strategy and agree with Natural England.  Apply for a conservation licence for water vole trapping.	Consultant		Water vole licence and Method Statement submitted to NE in February 2012.		
		Water vole surveys in advance of works.  Surveys of the South Eau to be undertaken by boat to allow full access.	Consultant Ecologist  Contractor to provide boat and pilot.	Water vole Mitigation Method Statement	Surveys due to commence first week of March.  Vegetation can be cut back and the reeds topped, to prevent birds nesting prior to water vole surveys, if required.		
		Carry out the mitigation as specified in the water vole method statement.	Consultant Ecologist (Surveys and monitoring)  Contractor (all other works including supply of boat/pilot).	Water vole Mitigation Method Statement			
A2.5	To prevent adverse effects on protected species: Badger	Prepare Badger Method Statement.	Consultant	Badger mitigation method statement	Method Statement updated following NE and EA Fisheries & Biodiversity comments.	Yes	
		Apply for Development Licence from Natural England to damage / disturb / interfere with a badger sett(s).	Consultant	As above	Application submitted in February 2012.		

Ref. No.	Objective	Action	Responsibility	Ref. to Additional Information	Further Action / Comments	Sign Off	Date of Revision
<b>A PRIOR TO CONSTRUCTION</b>							
A2.5 (cont'd)	To prevent adverse effects on protected species:	Monitor the 17 setts that need to be closed to allow works for 30 days (February 2012).	Consultant Ecologist	As above	Monitoring commenced in February 2012.		
	Badger (continued)	Close any inactive setts immediately (March 2012).	Contractor under supervision from Consultant Ecologist	As above			
		Install protective fencing 30m from any active setts and maintain until they can be closed or works are completed.	Contractor	As above			
		Closure of remaining active setts – from July onwards.	Contractor under supervision of EcCW	EAP Clause B2.5			
A2.6	To minimise disturbance to fisheries	Prepare a fish rescue method statement for the section of the South Eau that will be dammed and pumped out.	Contractor		Environment Agency Fisheries Officers will advise. Commission fish rescue by suitably qualified personnel.		
		Develop a Pollution Incident Response Plan (PIRP) with reference to Environment Agency Pollution Prevention Guidance (PPG).	Contractor	Environment Agency PPG 01, 02, 05, 06 & 21			
A2.7	To inform work force on importance of site	Site induction must include information on statutory designations and mitigation required for protected species.	Contractor				



Ref. No.	Objective	Action	Responsibility	Ref. to Additional Information	Further Action / Comments	Sign Off	Date of Revision
<b>A PRIOR TO CONSTRUCTION</b>							
<b>3 LANDSCAPE AND VISUAL AMENITY</b>							
A3.1	Obtain approval from ELDC for the landscaping scheme	Submit proposed landscaping and tree planting scheme to ELDC for approval. This will indicate the number, species, heights on planting and positions of all the trees, together with details of post-planting maintenance.	Consultant	Planning Condition 10  EAP Clause C3.1	Draft drawings discussed at TAG meeting 28/11/11.  Drawings submitted to ELDC on 06/01/12.		
A3.2	Obtain approval for interpretation and information boards	Identify boards needed, design and submit to LPA for approval.	Environment Agency (NEAS)	Planning Condition 8  EAP Clause A5.2	Design ongoing.  Archaeological interpretation board (Pye's Hall) must be approved before works start to meet Planning Condition 8. Others will be approved before being installed.		
<b>4 TRAFFIC AND TRANSPORT</b>							
A4.1	Minimise disruption to local transport network	Produce a Traffic Management Plan (TMP) for the works. Organise access routes, timings of plant movement etc. for construction works on a TMP to ensure minimise effects on the local traffic network.	Contractor				

Ref. No.	Objective	Action	Responsibility	Ref. to Additional Information	Further Action / Comments	Sign Off	Date of Revision
<b>A PRIOR TO CONSTRUCTION</b>							
A4.1 (cont'd)	Minimise disruption to local transport network (continued)	Give adequate notice and publicity of plant arrival and other deliveries to residents that may be affected.	Public Liaison Officer				
		Access to current car park clearly signed to separate public and construction traffic.	Contractor				
A4.2	Ensure highway safety	Carry out a condition audit of the roads between Stonebridge car park and the A1031, all in North Somercotes and Donna Nook, and submit to LPA.  Road audits must be undertaken for each phase of the works.	Contractor	Planning Condition 15			
		Confirm with ELDC the exact roads that need to be audited	Consultant (Axis) / EA Legal		Ongoing as part of s278 Agreement consultation.		
A4.3	Agree timetable for works on Marsh Lane prior to undertaking breach works	Provide LPA timetable of highways works.  Ensure Marsh Lane is of a satisfactory standard for visitor access.	Contractor / Consultant (Axis)	Planning Condition 2	Ongoing as part of s278 Agreement consultation.		
A4.4	Reduce disturbance from people abusing the car parking facility	Car park will be designed to reduce the speed of vehicles and discourage anti-social behavior.	Consultant	Detailed design drawings			

Ref. No.	Objective	Action	Responsibility	Ref. to Additional Information	Further Action / Comments	Sign Off	Date of Revision
<b>A PRIOR TO CONSTRUCTION</b>							
<b>5 HISTORIC ENVIRONMENT</b>							
A5.1	To protect archaeological assets	Document a detailed mitigation procedure to follow in the event of timber, masonry or any other artefacts being uncovered.	Environment Agency Archaeological Officer				
		An archaeological tool box will be given to the workforce by an appropriate person using photographs to show what archaeological assets might be found whilst working on the site, with an explanation of what actions would be required should such assets be found.	ECW/Environment Agency Archaeological Officer				
A5.2	To record known archaeological assets in the managed realignment area.	Submit a scheme of archaeological recording of the earthworks relating to Pye's Hall to ELDC for approval in writing.	EA Archaeological Officer	Planning Condition 16	Geophysical survey of former Pye's Hall carried out on 21 September 2011.  Interpretation board (recording) design ongoing.		
<b>6 SOILS, GEOLOGY, WATER AND HYDROGEOLOGY</b>							
A6.1	To protect groundwater	Carry out further desk study and site investigations to locate the historical boreholes on the site around the former Pye's Hall.	Environment Agency (in parallel with archaeological recording)	Results of geophysical survey.  Historical maps of the site  EAP Clause B6.4	Geophysical survey of former Pye's Hall carried out on 21 September 2011: boreholes were not detected.	Yes	

Ref. No.	Objective	Action	Responsibility	Ref. to Additional Information	Further Action / Comments	Sign Off	Date of Revision
<b>A PRIOR TO CONSTRUCTION</b>							
A6.1 (cont'd)	To protect groundwater (continued)	Prepare borehole capping method statement in the event that a borehole is uncovered during construction works.	Contractor		May need trial excavations to locate boreholes if defined in WFD assessment.		
A6.2	To protect soils, water and groundwater	Carry out an incident response trial run for dealing with a hydrocarbon spill.	Contractor				
<b>7 LAND USE</b>							
N/A							
<b>8 USE OF NATURAL RESOURCES AND WASTE GENERATION</b>							
A8.1	To minimise the amount of waste taken to landfill and ensure compliance with legal controls	Prepare a Site Waste Management Plan to consider the waste types and quantities that are likely to be produced during the course of the project, with management actions including re-use, recycling, recovery and disposal, and a declaration that waste will be managed appropriately and in accordance with the Duty of Care. Liaise with EA Environmental Management Team about Waste Management.	Contractor	Design Stage Site Waste Management Plan			

Ref. No.	Objective	Action	Responsibility	Ref. to Additional Information	Further Action / Comments	Sign Off	Date of Revision
<b>B DURING CONSTRUCTION</b>							
<b>1 HUMAN BEINGS AND HEALTH</b>							
B1.1	To protect people by controlling noise & vibration disturbance, caused by construction activities	Implement noise monitoring plan. Contact EHO if noise is going to exceed limits set and agree mitigation measures prior to that noise being created.  Prevent unnecessary construction noise by: <ul style="list-style-type: none"> <li>• locating fixed machinery as far away from properties as practical and using noise screens;</li> <li>• keeping construction machinery well maintained and switching off when not in use;</li> <li>• use of suitably sized construction machinery;</li> <li>• training in the form of tool-box talks to site staff.</li> </ul>	Contractor	Environment Agency's PPG No. 6 'Working at Construction & Demolition Sites'  BS5228: 1997, Part 1, Annex B 'Noise Control and Open Sites'.			
		There must be no tonal reversing beepers used on any construction vehicle operating on the application site unless formally agreed with ELDC. Health and safety concerns dealt with in an alternative manner.	Contractor	Decision Notice, Planning Condition 7	ELDC accept use of white noise reversing alerts instead (letter 28/02/12)	Yes	

Ref. No.	Objective	Action	Responsibility	Ref. to Additional Information	Further Action / Comments	Sign Off	Date of Revision
<b>B DURING CONSTRUCTION</b>							
B1.1 (cont'd)	To protect people by controlling noise & vibration disturbance, caused by construction activities  (continued)	Adhere to the Environment Agency's Pollution Prevention Guideline (PPG) No. 6. and recommendations set out in BS5228: 1997.	Contractor				
		Conform to principles specified within the Considerate Contractor Scheme.	Contractor				
		Complaints to be reported immediately to the EA Project Manager.	Contractor				
B1.2	To maintain public access to PRow and beach throughout construction works	Public car parking will be maintained for public use throughout construction period.	Contractor	Planning Condition 3			
		Footpath diversions will be put in place when required. Maintain clearly visible footpath closure and diversion notices.	Contractor	EAP Clause A1.3			
		Maintain vehicle access to beach and access to track at back of dunes for MoD, coastguard and pedestrian access to NNR.	Contractor				

Ref. No.	Objective	Action	Responsibility	Ref. to Additional Information	Further Action / Comments	Sign Off	Date of Revision
<b>B DURING CONSTRUCTION</b>							
B1.2 (cont'd)	To maintain public access to PRoW and beach throughout construction works (continued)	The necessary works to create the replacement PRoW along the new embankment must be carried out on site before the existing public footpath is closed.	Contractor	Planning Condition 9 EAP Clause A1.4			
		The proposed permissive path must be provided before the breach in the existing flood embankment is created.	Contractor	Planning Condition 9			
		The replacement public car park must be provided on site in accordance with LPA approval, prior to the removal of the old car park.	Contractor	Planning Condition 3			
B1.3	To communicate information about the works	Review and implement Communications Plan for Construction Stage e.g. new letters notifying of deliveries etc.	Environment Agency Communication / Public Liaison Officer	Communications Plan			
		Give ELDC and MoD not less than 10 days notice of the date on which the existing flood defences on the site will be breached.	Environment Agency Communications	S106 agreement, Clause 4.2 Communications Plan			

Ref. No.	Objective	Action	Responsibility	Ref. to Additional Information	Further Action / Comments	Sign Off	Date of Revision
<b>B DURING CONSTRUCTION</b>							
B1.4	To carry out works within sociable hours	<p>There must be no works carried out on site between the hours of 7pm and 7am or on a Saturday or Sunday nor must there be any deliveries brought to or from the site other than between the hours of 8am to 5.30pm Monday to Friday.</p> <p>Any working outside of these hours must be agreed in writing with ELDC prior to commencement.</p>	Contractor	Planning Condition 6			
B1.5	Prevent/minimise obstructions by work traffic	Plant and other site machinery not to block access to local properties or amenities.	Contractor				
B1.6	Publicise permanent footpath diversion	Publicise new route at Donna Nook and at suitable access points along the coast and at new car park.	Contractor	Communications Plan EAP Clause A1.4			



Ref. No.	Objective	Action	Responsibility	Ref. to Additional Information	Further Action / Comments	Sign Off	Date of Revision
<b>B DURING CONSTRUCTION</b>							
B1.7	Asbestos Survey Report	<p>Follow provisions of the Asbestos Management Plan when working at the pumping station.</p> <p>If necessary, asbestos-containing material to be removed by a HSE Licenced contractor under the control of Asbestos Regulations 2006 Approved Code of Practice L143 and disposed of as hazardous waste.</p>	Contractor	EAP Clause A1.10			
<b>2 FLORA AND FAUNA</b>							
B2.1	To maintain the integrity of the Humber Estuary SAC/SPA/Ramsar site/SSSI	No construction work will be carried out between November and March* inclusive unless otherwise agreed in writing with ELDC.	Contractor	Planning Condition 13	NE has approved working in October and April subject to certain conditions (see below). Formal approval received from ELDC to work in October and April (30/01/12).		

Ref. No.	Objective	Action	Responsibility	Ref. to Additional Information	Further Action / Comments	Sign Off	Date of Revision
<b>B DURING CONSTRUCTION</b>							
B2.1 (cont'd)	To maintain the integrity of the Humber Estuary SAC/SPA/Ramsar site/SSSI  (continued)	<p>If formal agreement is received from ELDC the works in April and October will be carried out subject to the following restrictions:</p> <ul style="list-style-type: none"> <li>• No earthworks to create site access for 1.5 hours either side of high tide (i.e. 3 hours in total) in April (mobilisation and compound set up).</li> <li>• No deliveries of equipment or materials to site for 1.5 hours either side of high tide (i.e. 3 hours in total) in April (mobilisation and compound set up).</li> <li>• No removal of equipment from site for 1.5 hours either side of high tide (i.e. 3 hours in total) in October (phase 1 demobilisation).</li> <li>• No work within 200m of the SPA and SAC boundary for 1.5 hours either side of high tide (i.e. 3 hours in total) or during storms.</li> </ul>	Contractor	EAP Clause A2.2	Restrictions on mobilisation / demobilisation avoid disturbance to overwintering birds from large vehicles passing through Stonebridge Car Park.		

Ref. No.	Objective	Action	Responsibility	Ref. to Additional Information	Further Action / Comments	Sign Off	Date of Revision
<b>B DURING CONSTRUCTION</b>							
B2.1 (cont'd)	To maintain the integrity of the Humber Estuary SAC/SPA/Ramsar site/SSSI  (continued)	Channel works on the foreshore at the breach site to be after April.	Contractor	Environmental Statement.  ELDC letter of agreement under Condition 13	To avoid disturbing overwintering birds during foreshore works.		
		Follow the agreed Method Statement for works in dunes (tie-ins). Restore existing car park to sand dune.	Contractor	Dune works method statement  EAP Clause A2.2.  Detailed design drawings.			
B2.2	To minimise disturbance to the grey seal colony located on site	Works at breach site will take place between April and October during which time the seals do not use the beach.  No work on the foreshore will take place in April.	Contractor	Planning Condition 13	Formal agreement required to work in April and October from ELDC – see B2.1.		
B2.3	To create new replacement and compensatory habitat	Create habitat to specification agreed with NE.  Create habitat as shown on habitat creations plans, under supervision of the ECW / EcCW.	Contractor	Environmental Statement  Landscape Planting Plans	Pond margins to be inoculated by silts provided by Lincolnshire Wildlife Trust (LWT) from local National Nature Reserve (NNR). Expected to be available in September.		

Ref. No.	Objective	Action	Responsibility	Ref. to Additional Information	Further Action / Comments	Sign Off	Date of Revision
<b>B DURING CONSTRUCTION</b>							
B2.4	To prevent adverse effects on protected species: Water Vole	Regular strimming of re-growth throughout working area to prevent recolonisation.	Contractor under EcCW instruction	Water vole mitigation method statement			
		Monitor for signs that animals have returned to the working areas.  Follow the methods described in the water vole mitigation method statement to remove voles from the working area.	EcCW  Contractor under EcCW direction.	Water vole mitigation method statement			
		Construct new soke dyke with profiles to encourage vegetation appropriate for water vole habitat and suitable banks for burrowing.  Seed banks will be sown with appropriate grass mix (Emorsgate EM8 grass mix).	Contractor	Construction drawings and specifications  Water vole mitigation method statement Section 6.4 for seed mix			
B2.5	To prevent adverse effects on protected species: Badgers	Maintain 30m exclusion zones around all active sett entrances.  If works are needed within the exclusion zones, discuss with EcCW to determine how to proceed.	Contractor  Contractor / EcCW	Badger mitigation method statement			

Ref. No.	Objective	Action	Responsibility	Ref. to Additional Information	Further Action / Comments	Sign Off	Date of Revision
<b>B DURING CONSTRUCTION</b>							
B2.5 (cont'd)	To prevent adverse effects on protected species:  Badgers (continued)	Close active setts under licence, as per mitigation method statement:	EcCW (survey) Contractor	Badger mitigation method statement			
		<ul style="list-style-type: none"> <li>• Assess status of remaining setts (June)</li> <li>• Exclusion (July onwards)</li> <li>• Close all setts impacted by 2012 works: Leave fencing/gates in place at setts 6, 7 &amp; 29.</li> <li>• Close setts 6, 7 &amp; 29 (November).</li> </ul>					
		Any additional setts found on site will be discussed with NE and where necessary exclusion zones will be set up or the setts closed under licence.	EcCW	Badger mitigation method statement			
		Cover all excavations at the end of the working day, or provide a safe method of egress for badgers, to prevent entrapment.	Contractor				
		Store site materials, fuel, waste and machinery safely and securely so that they do not pose a risk to inquisitive badgers overnight.	Contractor				

Ref. No.	Objective	Action	Responsibility	Ref. to Additional Information	Further Action / Comments	Sign Off	Date of Revision
<b>B DURING CONSTRUCTION</b>							
B2.5 (cont'd)	To prevent adverse effects on protected species:  Badgers (continued)	If required use electric fencing during construction to discourage badgers from digging into the new embankments sections as they are under construction.	Contractor				
		Place fencing to deter public access and dogs from main badger sett post-construction along permissive path.	Contractor	Design drawings			
B2.6	To avoid disturbance to nesting birds	<p>Check of all new working areas for nesting birds including ground nesting and water fowl. If nesting birds are found, no works shall be carried out until advice has been received from EcCW on how to proceed. Monitor working areas for new nests.</p> <p>Undertake mitigation as agreed with NE prior to the breach if to be undertaken inside bird breeding season.</p>	EcCW / Contractor				
B2.7	Protect fisheries interest in the Seven Towns South Eau system	Undertake fish rescue when a section of the South Eau is dammed and pumped out as required by Environment Agency Fisheries.	Contractor		Fish rescue method statement. EAP Clause A2.6		

Ref. No.	Objective	Action	Responsibility	Ref. to Additional Information	Further Action / Comments	Sign Off	Date of Revision
<b>B DURING CONSTRUCTION</b>							
B2.7 (cont'd)	Protect fisheries interest in the Seven Towns South Eau system  (continued)	Provision of a fish scarer to reduce the risk of fish entrapment and mortality in pumping station machinery. Design to be agreed with Environment Agency Fisheries.	Contractor		Outline design agreed with Chris Randall (F&B)		
		Construct an eel pass within new pumping station.	Contractor	Design Drawings			
		Prevent contamination of water by following the storage and pollution incident response requirements of EAP clause B6.2.		Pollution Incident Response Plan (PIRP) EAP Clause B6.2			
B2.8	To minimise environmental incidents	Any environmental incidents to be reported and action taken. Report to Environment Agency hotline 0800 80 70 60 and Environment Agency PM and NEAS Officer.	ECW / Contractor				
B2.9	To prevent the spread of invasive weeds in accordance with the Wildlife and Countryside Act 1981 (as amended)	No invasive species have been identified on site prior to construction. A Bio-security risk assessment will be produced to prevent invasive species being brought onto site.	Contractor				

Ref. No.	Objective	Action	Responsibility	Ref. to Additional Information	Further Action / Comments	Sign Off	Date of Revision
<b>B DURING CONSTRUCTION</b>							
B2.10	Ensure no increased risk of bird strike	Monitor site to ensure no activities are encouraging increased numbers of birds that could result in the risk of bird strike e.g. gulls/geese. No food to be dropped on site or fed to birds. Notify MoD and NE if potential issue and agree mitigation strategy.	ECW / EcCW Contractor				
B2.11	Ensure no danger to birds and seals	In accordance with the SWMP all plastic bags and wrappers to be removed from site daily and stored in closed skip to prevent risk of escape.	Contractor	Site Waste Management Plan			
B2.12	To protect the orchid population of the sand dunes	Carry out orchid survey(s) in Summer 2012.  Translocate orchids to nearest suitable location if necessary for bank-dune tie-ins.  Use a large bucket (not an auger) for translocations.  Translocation to be overseen by EcCW.	EcCW  Contractor under ecological supervision		Valid surveys can only be carried out when in flower: Bee orchid (June/July), Fly orchid (May/June), Pyramidal (June/August), Marsh helleborine (July/August).		



Ref. No.	Objective	Action	Responsibility	Ref. to Additional Information	Further Action / Comments	Sign Off	Date of Revision
<b>B DURING CONSTRUCTION</b>							
B2.13	Develop Monitoring and Management Strategy	<p>Submit a Monitoring and Management Strategy for the site to ELDC for approval within 6 months of commencement of development on site.</p> <p>This shall include arrangements to monitor vegetation/saltmarsh; benthic invertebrates, birds and fish.</p>	Environment Agency NEAS	<p>Planning Condition 11</p> <p>EAP Clause B6.3</p>			
B2.14	To provide suitable surface for little tern breeding islands	The little tern islands will be surfaced with granular material comprising a mix of coarse sand, gravel and shingle, plus some larger stones and shells.	Contractor	<p>Environmental Statement</p> <p>s106 agreement, Second Schedule (Bird Management Plan), Section 5.2</p>			
B2.15	To provide natural protection for nesting little terns	Construct a deep channel around the smallest island - same depth as the South Eau.	Contractor				

Ref. No.	Objective	Action	Responsibility	Ref. to Additional Information	Further Action / Comments	Sign Off	Date of Revision
<b>B DURING CONSTRUCTION</b>							
<b>3 LANDSCAPE AND VISUAL AMENITY</b>							
B3.1	To maintain an acceptable site appearance during construction period	Maintain the working areas in a tidy and orderly manner throughout the contract period.	Contractor				
		Store segregated waste materials in a dedicated area of the compound in clearly labeled containers, which are in good condition and covered.  Clear any spilled debris daily.  Compound securely fenced and maintained to the satisfaction of the site supervisor and ECW.	Contractor / ECW				

Ref. No.	Objective	Action	Responsibility	Ref. to Additional Information	Further Action / Comments	Sign Off	Date of Revision
<b>B DURING CONSTRUCTION</b>							
<b>4 TRAFFIC AND TRANSPORT</b>							
B4.1	Minimise disruption to local transport network	<p>Comply with the TMP. All site workers to use official access routes as defined in the TMP. Access to car park will be designed to clearly split construction and public traffic. Local residents to be advised when large loads will be delivered.</p> <p>Monitor condition of roads between Stonebridge car park and the A1031 used for construction traffic and repair as necessary.</p>	Contractor	<p>Traffic Management Plan (EAP Clause A4.1)</p> <p>Condition Audit (EAP Clause A4.2)</p> <p>Planning Condition 13</p>			
B4.2	To improve Marsh Lane	Agree a timetable for completing the widening / improvements to Marsh Lane with ELDC and LCC before works to breach the existing embankment commence.	Contractor	S278 Agreement Planning Condition 2	Highways to provide detailed design.		

Ref. No.	Objective	Action	Responsibility	Ref. to Additional Information	Further Action / Comments	Sign Off	Date of Revision
<b>B DURING CONSTRUCTION</b>							
<b>5 HISTORIC ENVIRONMENT</b>							
B5.1	To protect archaeological assets	<p>In the event of timber, masonry or other artefacts being unearthed follow the documented procedure of:</p> <p>Report to Environment Agency NEAS Archaeological Officer and allow for its examination and if necessary, it's recording.</p> <p>Cease works in the area immediately until the Environment Agency NEAS Archaeological Officer has confirmed work can continue.</p>	Contractor	<p>Archaeological Mitigation Strategy (EAP Clause A5.1)</p> <p>A Watching Brief was present during site investigations in 2008 and 2009. Due to the lack of archaeological features found a Watching Brief will not be required during main construction.</p>			

Ref. No.	Objective	Action	Responsibility	Ref. to Additional Information	Further Action / Comments	Sign Off	Date of Revision
<b>B DURING CONSTRUCTION</b>							
<b>6 SOILS, GEOLOGY, WATER AND HYDROGEOLOGY</b>							
B6.1	To minimise soil compaction and erosion, and maintain the quality of the topsoil to be stripped and reused within the development	<p>Topsoil must not be handled or trafficked:</p> <ul style="list-style-type: none"> <li>during, or shortly after, heavy precipitation;</li> <li>in a waterlogged condition;</li> <li>when the ground is frozen or covered by snow; and</li> <li>when there are pools of water on the ground surface.</li> </ul> <p>Whenever possible, move soil directly from where it is stripped to the stockpiles.</p> <p>Store topsoil in bunds no higher than 1 metre when loose-tipped.</p> <p>Store subsoil in bunds no higher than 3m.</p> <p>Keep topsoil stockpiles separate from subsoil stockpiles.</p> <p>Do not track vehicles or machines over stockpiles.</p>	Contractor	BS3882:2007 'The British Standard for Topsoil'  Section 5.4 Handling  Section 5.5 Storage			

Ref. No.	Objective	Action	Responsibility	Ref. to Additional Information	Further Action / Comments	Sign Off	Date of Revision
<b>B DURING CONSTRUCTION</b>							
B6.1 (cont'd)	Soil (continued)	<p>If topsoil is to be stored for longer than six months, sow the heaps with a grass seed mix containing a minimum of 20% F1 hybrid fast germinating sterile annual ryegrass at an application rate of 25 – 30 gms/m<sup>2</sup>. No perennial ryegrass seed will be used.</p> <p>Where ground is too soft to run over in temporary working areas, strip top and subsoil and store separately.</p>					
B6.2	To prevent soils, water and groundwater contamination	<p>Comply with all recommendations of the Environment Agency Pollution Prevention Guidelines.</p> <p>Drip trays in place under all static plant when running and when not in use.</p> <p>Adopt industry standard working methods.</p>	Contractor	<p>Pollution Incident Response Plan (PIRP) (EAP Clause A2.6)</p> <p>Environment Agency PPG: PPG1: General guide to the prevention of water pollution</p>			

Ref. No.	Objective	Action	Responsibility	Ref. to Additional Information	Further Action / Comments	Sign Off	Date of Revision
<b>B DURING CONSTRUCTION</b>							
B6.2 (cont'd)	To prevent soils, water and groundwater contamination  (continued)	<p>Machinery and plant including hoses, fixings and fuel lines must be checked at least weekly and replaced if signs of wear</p> <p>Machinery and plant to be regularly maintained and kept in good condition.</p> <p>Fuel and hazardous materials will be stored within suitably bunded, signed areas within compound.</p> <p>Biodegradable oil must be used in construction machinery.</p>		<p>PPG5: Works in, near or liable to affect watercourses</p> <p>PPG6: Working at construction and demolition sites</p> <p>PPG21: Pollution incidence response planning</p> <p>PPG23: Maintenance of structures over water</p>			
		<p>Topsoil strip in areas of historic boreholes (Pye's Hall). If boreholes found during topsoil strip or other excavations, follow agreed methodology to cap the boreholes.</p>	Contractor	Historic maps of borehole locations			

Ref. No.	Objective	Action	Responsibility	Ref. to Additional Information	Further Action / Comments	Sign Off	Date of Revision
<b>B DURING CONSTRUCTION</b>							
B6.3	Develop Monitoring and Management Strategy (to include erosion and sedimentation aspects of site development)	Submit a Monitoring and Management Strategy for the site to ELDC for approval within 6 months of commencement of development on site.  This shall include arrangements to monitor accretion, deposition, ground levels, and vegetation/saltmarsh.	Environment Agency NEAS	Planning Condition 11  EAP Clause B2.13			
B6.4	Prevent saline intrusion into the underlying chalk aquifer via historical boreholes at Pye's Hall	Look for evidence of the three historical boreholes during ground clearance of the site prior to the breach in defences being made.  If found, decommission them in accordance with Environmental Agency guidelines	Contractor	<i>Decommissioning Redundant Boreholes and Wells</i> , National Groundwater & Contaminated Land Centre, Environment Agency  EAP Clause A6.1  WFD assessment			
<b>7 LAND USE</b>							
B7.1	To minimise impacts arising from tracking of machinery	Plant and machinery will be restricted to defined access routes/construction zones.	Contractor		Key areas are those to be retained as terrestrial habitat / grazing land.		



Ref. No.	Objective	Action	Responsibility	Ref. to Additional Information	Further Action / Comments	Sign Off	Date of Revision
<b>B DURING CONSTRUCTION</b>							
B7.2	To prevent effects on land drainage outside of the managed realignment site during refurbishment of Porter's Sluice pumping station	During the refurbishment works, the existing Porter's Sluice pumps will be used, in conjunction with mobile pumps if necessary, to ensure that pumping capacity is sufficient to maintain water levels in the South Eau at or below normal levels. This will be detailed within the contractor's method statement prior to work commencing on the pumping station.	Contractor				
B7.3	To prevent flooding	The refurbishment of Porter's Sluice Pumping Station must be completed prior to construction of new embankments.	Contractor	Planning Condition 4	Interpretation of 'construction' deemed to be 'works completed'. i.e., the pumping station is to be fully refurbished prior to the bank being fully formed to create a barrier to water movement.		
		New flood embankment must be built in accordance with approvals received from ELDC and must be completed prior to removal of existing embankment.	Contractor	Planning Condition 5			

Ref. No.	Objective	Action	Responsibility	Ref. to Additional Information	Further Action / Comments	Sign Off	Date of Revision
<b>B DURING CONSTRUCTION</b>							
<b>8 USE OF NATURAL RESOURCES AND WASTE GENERATION</b>							
B8.1	Comply with Site Waste Management Plan (SWMP)	Segregate waste, reuse, recycle and dispose. Undertake regular audits of SWMP and undertake corrective actions. All timber will be Forestry Stewardship certified and/or from sustainable and legal sources. Reuse temporary haul road site access and compound materials in subsequent phases of works wherever possible.	Contractor	Site Waste Management Plan (EAP Clause A8.1)			

Ref. No.	Objective	Action	Responsibility	Ref. to Additional Information	Further Action / Comments	Sign Off	Date of Revision
<b>C POST CONSTRUCTION</b>							
<b>1 HUMAN BEINGS AND HEALTH</b>							
C1.1	To ensure no increase in bird strike risk	Monitor bird use of realignment area. Carry out mitigation as required as agreed with MoD if species or numbers are considered to increase bird strike risk.	Environment Agency PM	Monitoring and Management Strategy (EAP Clause C2.3) s106 Agreement, Second Schedule (Bird Management Plan)			
C1.2	To protect local community	Continue consulting with the local community to identify any problems and possible solutions.	Environment Agency Communications				
<b>2 FLORA AND FAUNA</b>							
C2.1	To restore habitats disturbed to pre-construction conditions.	In appropriate locations, e.g. landward of the embankment, working area must be restored to previous condition or better.	Contractor	Restoration Method Statement for works in dunes. Landscape Plans			
C2.2	To ensure continued nature conservation	Implement and follow Monitoring and Management Strategy as developed and submitted to ELDC during construction.	Environment Agency PM	Decision Notice, Planning Condition 11 EAP Clause B2.13			

Ref. No.	Objective	Action	Responsibility	Ref. to Additional Information	Further Action / Comments	Sign Off	Date of Revision
<b>C POST CONSTRUCTION</b>							
C2.3	To ensure continued protection of over-wintering birds	Implement in full the approved mitigation and monitoring scheme for over-wintering birds, specifically Brent Geese. Any changes to the mitigation and monitoring scheme must be agreed in writing with ELDC.	Environment Agency PM	Planning Condition 14 EAP Clause A2.2			
C2.4	To maintain the little tern islands as suitable habitat and to reduce the risk that they become colonised by gulls as roost sites	Clear all vegetation from the islands in February/March and September/October in each year.  Recharge the surfacing materials when necessary.	Environment Agency Operations or appointed agent	Environmental Statement  s1106 agreement, Second Schedule (Bird Management Plan), Section 5.2  Monitoring and Management Strategy (EAP Clause B6.3)			
C2.5	To maintain quality of natterjack toad habitat	Maintain natterjack toad scrapes and surrounding habitats after they have been created.	Environment Agency Operations or appointed agent				

Ref. No.	Objective	Action	Responsibility	Ref. to Additional Information	Further Action / Comments	Sign Off	Date of Revision
<b>C POST CONSTRUCTION</b>							
C2.6	Introduce natterjack toads when habitat is suitably established	Obtain natterjack toad translocation licence as agreed with NE.	Environment Agency F&B or appointed agent	Animals will probably be from introduced populations at Saltfleetby, once they have established - probably 2013/2014 to introduce			
<b>3 LANDSCAPE AND VISUAL AMENITY</b>							
C3.1	To compensate for the loss of approximately 50 linear metres of hedgerow	Implement planting scheme on or adjacent to Donna Nook site as agreed with NE if translocation not successful.	Contractor under the Landscape works framework agreement	Landscape Plans EAP Clause A3.1			
C3.2	To mitigate the impact of the refurbished Porter's Sluice pumping station	Implemented localised screen planting.	Contractor under the Landscape works framework agreement	Landscape Plan EAP Clause A3.1			

Ref. No.	Objective	Action	Responsibility	Ref. to Additional Information	Further Action / Comments	Sign Off	Date of Revision
<b>C POST CONSTRUCTION</b>							
C3.3	To ensure successful establishment of landscape planting	All trees, shrubs and bushes will be maintained for five years from the date of completion. During that period all losses shall be made good as and when necessary, unless ELDC gives written consent to any variation.	Contractor under the Landscape works framework agreement	EAP Clause A3.1 Planning Condition 10			
<b>4 TRAFFIC AND TRANSPORT</b>							
C4.1	To ensure roads are re-instated	Roads between Stonebridge car park and the A1031 used for construction access and temporary areas of works must be restored to previous or better condition, to a condition agreed with ELDC.	Contractor	Planning Condition 15 Pre-construction condition audit (EAP Clause A4.2)			
<b>5 HISTORIC ENVIRONMENT</b>							
C5.1	To protect archaeological assets	In the event of discovering any archaeological assets, a proportionate scheme of archaeological recording and publication will be undertaken.	Environment Agency NEAS Archaeological Officer				

Ref. No.	Objective	Action	Responsibility	Ref. to Additional Information	Further Action / Comments	Sign Off	Date of Revision
<b>C POST CONSTRUCTION</b>							
<b>6 SOILS, GEOLOGY, WATER AND HYDROGEOLOGY</b>							
C6.1	To monitor and understand the morphological evolution of the site	Implement and follow Monitoring and Management Strategy as developed and submitted to ELDC during construction.	Environment Agency or appointed agents	Planning Condition 11 EAP Clause B2.13			
<b>7 LAND USE</b>							
N/A							
<b>8 USE OF NATURAL RESOURCES AND WASTE GENERATION</b>							
C8.1	Leave no waste on site	Remove waste from site as per SWMP.	Contractor	Site Waste Management Plan (EAP Clause A8.1)			

## Schedule of Project-Specific Agreements and Management Plans

Agreement/Plan	Full Title	Version	Notes/Comments
Archaeological Mitigation Strategy	To be completed (TBC)	TBC	Geophysical survey carried out on 21 September 2011
Asbestos Survey Report	Asbestos Register based upon a Refurbishment & Demolition Survey Of Pump House, Donna Nook. City Environmental Services (EU) Ltd. Report number CESEU 015004	1, 29/11/2011	
Badger mitigation method statement	Donna Nook Managed Realignment: Badger Mitigation – Method Statement	Version 1.3: Final. January12	
Decision Notice	Full Planning Permission decision notice for N/132/00645/11	8th July 2011	
Communications Plan	TBC	TBC	Environment Agency Communications
Environmental Statement	Donna Nook Managed Realignment Environmental Statement	November 2009	
Habitats Regulations Assessment	Donna Nook Managed Realignment Habitats Regulations Assessment: Information for Habitats Regulations Assessment	November 2009, Rev E	
	Donna Nook Managed Realignment Habitats Regulations Assessment: Information for Habitats Regulations Assessment -Additional Information	April 2010, Rev G	Limited to additional assessment of potential in-combination effects
Geophysical survey	Data held by Jen Richards / Ed Wilson, EA	From 21 September 2011	Being incorporated into interpretation board
Landscape Planting and Maintenance Plan	Drawings 108898-8000-0001 to 108898-8000-0011	B (except 0003: C)	Submitted to ELDC for approval on 06/01/12, as per Planning Condition 10.
Magnetronomy Survey	Report on Magnetronomy Survey carried out May – September 2010	Bactec 3189_SR2, 29/09/10	
Restoration Method Statement for works in dunes	TBC	TBC	Contractor
Monitoring and Management Strategy	TBC	TBC	Environment Agency NEAS



Agreement/Plan	Full Title	Version	Notes/Comments
Pollution Incident Response Plan	TBC	TBC	Contractor
s106 Agreement	Deed of unilateral undertaking by (1) The Environment Agency and (2) L. G. Dawson Limited to East Lindsey District Council under Section 106 Town and Country Planning Act 1990 relating to a development consisting of a Managed Realignment Scheme at Donna Nook, Marsh Lane, North Somercotes.	6th July 2011	
s278 Agreement	TBC	TBC	Ongoing Environment Agency
Site Waste Management Plan	TBC	TBC	Contractor
Traffic Management Plan	Traffic Management Plan : C2541 Donna Nook Managed Re-Alignment	First Draft: 21/02/12	Birse Civils Ltd, Northern Division
Water vole mitigation method statement	Donna Nook Managed Realignment: Water Vole Mitigation – Method Statement	Version 1.3, Final. February 2012	
WFD Assessment	Donna Nook Water Framework Directive Assessment Final.doc	Final	



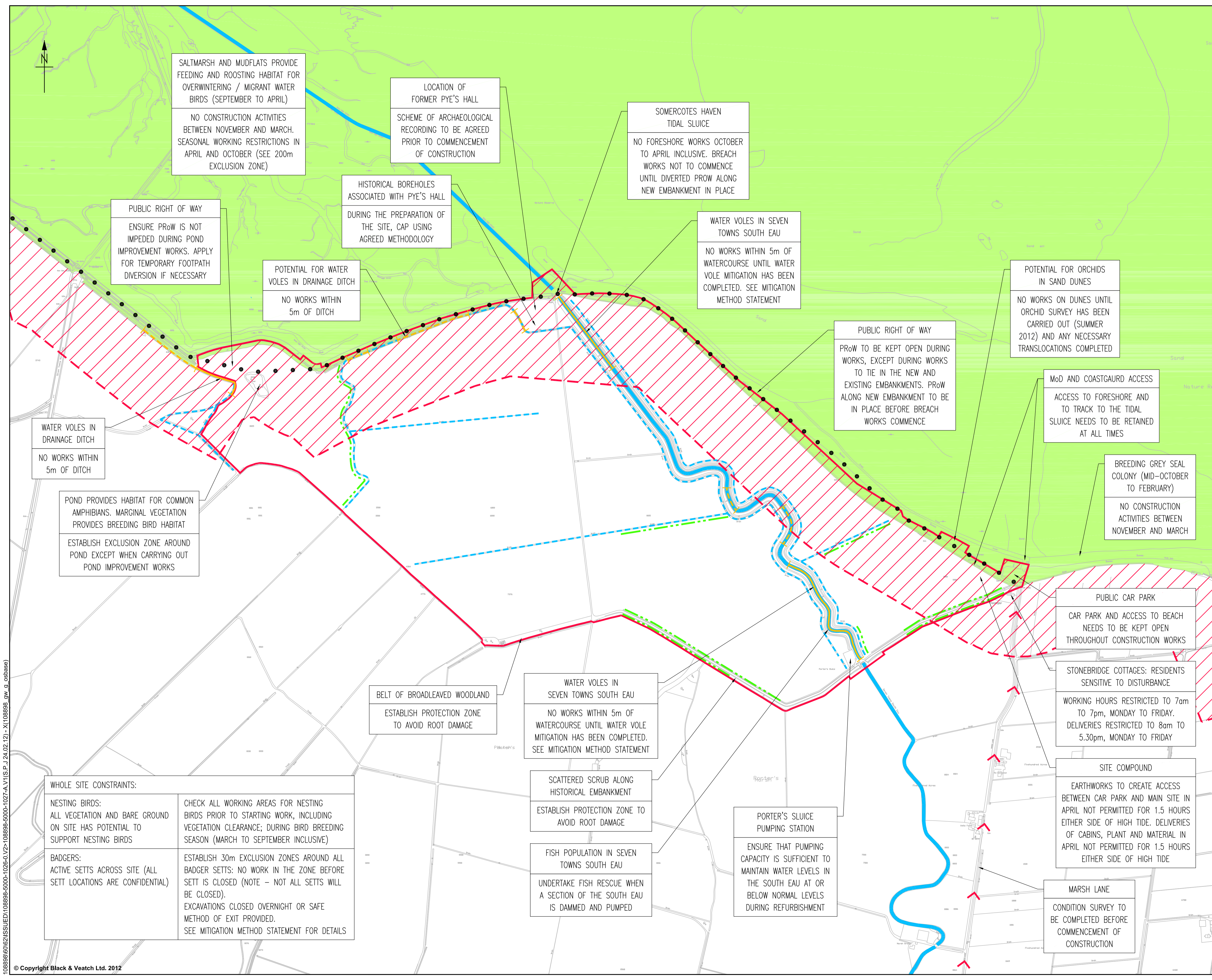

Note: The limits, including the height and depths of the Works, shown in this drawing are not to be taken as limiting the obligations of the contractor under Contract.

This Map is Reproduced from the Ordnance Survey Map by the Environment Agency with Permission of Her Majesty's Stationery Office Crown Copyright ©. Unauthorised reproduction infringes Crown Copyright and may lead to civil proceedings. Licence Number 100026380.

- LEGEND**
- SITE BOUNDARY
  - SEVEN TOWNS SOUTH EAU
  - - - DRAINAGE DITCH
  - ● ● PUBLIC RIGHT OF WAY
  - - - HEDGEROW
  - > ACCESS FROM NORTH SOMERCOTES AND A1031
  - STATUTORY NATURE CONSERVATION SITES
  - / / / 200m SEASONAL EXCLUSION ZONE: NO WORKS IN THIS AREA FOR 1.5 HOURS EITHER SIDE OF HIGH TIDE BETWEEN 1st OCTOBER AND 30th APRIL
  - CONFIRMED WATER VOLE PRESENCE (2011)
  - - - POSSIBLE WATER VOLE PRESENCE (2011)

**Safety Health and Environmental information**

In addition to the hazards/risks normally associated with the types of work detailed on this drawing, note the following:

Construction
Maintenance/Cleaning/Operation
Decommissioning/Demolition

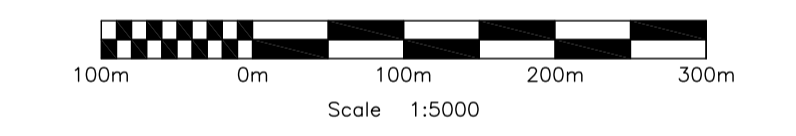

Rev	Drawn	Chkd	Rwd	App'd	Date	Description
A	SPJ	ABu	SPC	EAS	24.FEB.12	FOR WORKS INFORMATION

Designed by: REG Date: 23.JAN.12



Client drawing No. \_\_\_\_\_ Revision \_\_\_\_\_

**BLACK & VEATCH**  
 Black & Veatch Limited  
 Registered office  
 Grosvenor House, 80 London Road, Redhill, Surrey, RH1 1LD, United Kingdom  
 Tel: +44(0)1273 774 155 E-mail: bv@bv.com

Project: **DONNA NOOK MANAGED REALIGNMENT**

Drawing title: **ENVIRONMENTAL ACTION PLAN ENVIRONMENTAL CONSTRAINTS PLAN**

Drawing scale: 1:5000 Sheet size: A1

Drawing No.	Revision
108898 - 5000 - 1027	A

108898/60/02/ISSUED/108898-5000-1026-D.V2-108898-5000-1027-A.V1 (S.P.) 24.02.12 - X(108898\_gw\_g\_osbase)